

Name: _____ Date: _____

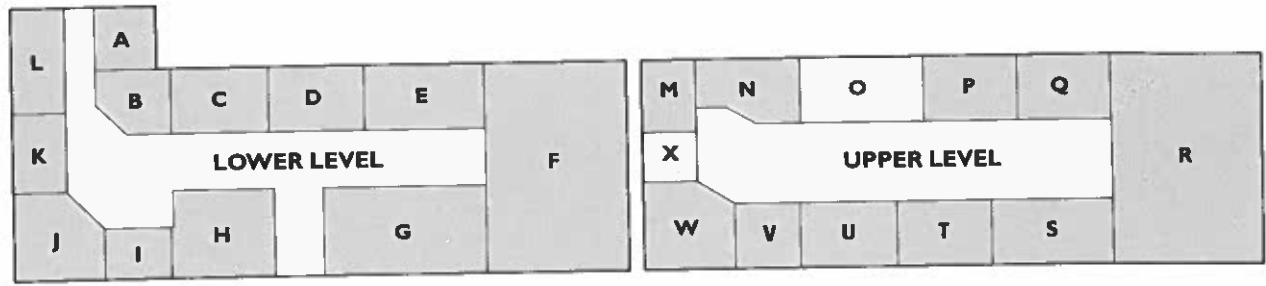

Reading a Shopping Mall Map

Directions Read the map below. Then, answer the questions.



MALL DIRECTORY			
Cards/Books		Shoes	
Heartfelt Wishes	B	Sensational Soles	C
Read All About It	E	Walking Wear	P
Department Stores		Specialty Shops	
Crest's	F	Gift Gallery	H
Fashions Galore	R	Howie's Collectibles	A
		Jammin' Sports	Q
Entertainment		Food	
Gamezzz	L	Chinatown	G
Toys		Hamburger Haven	W
Fun Zone	M	Pizza by the Slice	V
Kids' Kreations	D	Roberta's Tacos	X
The Toy Train	S	Music	
Jewelry		Pop Palace	N
Gold Gallery	J	Radio Review	K
Karat Korner	U	Services	
Pets		Mall Information	I
Adorable Animals	O	Roosevelt Bank	T

1. What two stores are next to Sensational Soles? _____

2. Which jewelry store is located on the lower level? _____
3. Which level is Roosevelt Bank on? _____

Name: _____ Date: _____



Reading a Shopping Mall Map continued

4. Which specialty shop is located on the upper level? _____
5. What store might you visit if you needed to buy bird seed? _____
6. What two stores is Roosevelt Bank between? _____

7. What three food shops are located next to each other on the upper level? _____

8. Why do you think these three food shops would be next to each other? _____

9. What store is at location A on the mall directory? _____
10. What store is at location M on the mall directory? _____
11. True or False? The mall information booth is located on the upper level. _____
12. What two stores have the most space in the mall? _____

13. Where are the two music stores located? _____

Directions Choose the best answer, and write the letter in the blank.

- _____ 14. If you needed to buy shoes and greeting cards, which two stores would you visit?
 - A. Pop Palace and Read All About It
 - B. Walking Wear and Karat Korner
 - C. Gamezzz and The Toy Train
 - D. Sensational Soles and Heartfelt Wishes

- _____ 15. Which of these stores would have a women's clothing section?
 - A. Howie's Collectibles
 - B. Crest's
 - C. Roosevelt Bank
 - D. Chinatown